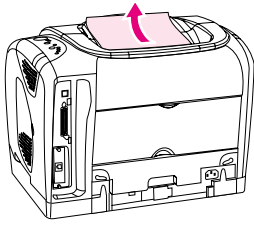
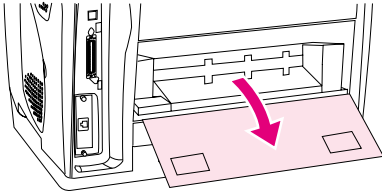
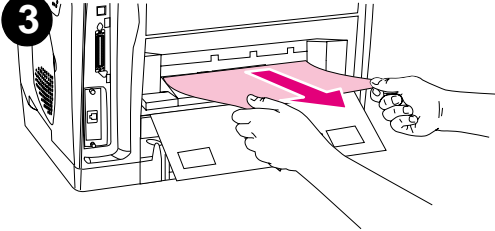
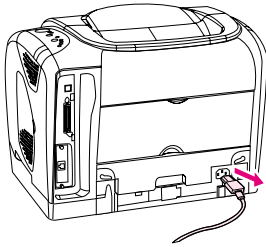
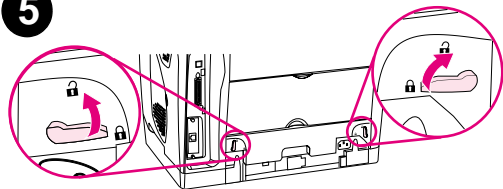

1**2****3****4****5**

To clear jams from output areas

CAUTION

Jams in these areas might result in loose toner on the page. If you get toner on your clothes or hands, wash them in cold water. (Hot water will set the toner into the fabric.)

1 Complete one of these steps:

- If the paper is not almost completely visible from the top output bin, proceed to step 2.
- If the paper is almost completely visible, pull it carefully out of the printer and proceed to the step 9.

2 Open the rear output door.

3 If the leading edge of the paper is visible from the rear opening, carefully pull the paper out.

4 If the jam is too far into the printer to remove, turn off the printer and disconnect the power cable.

CAUTION

Always turn off the printer and disconnect the power cable before you remove the fuser.

5 Rotate the locks on the fuser to the unlocked position.

6

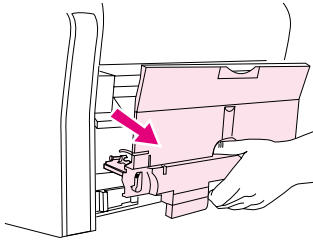



- 6 Grasp the fuser handles and pull to remove the fuser from the printer.

WARNING!

The parts on the internal surface of the fuser are very hot. To avoid burning yourself, do not touch those parts.

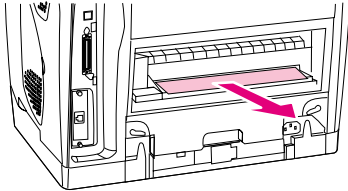
7



- 7 Using both hands, slowly and steadily remove any paper from inside the printer. Then, carefully reinsert the fuser and secure the locks.
- 8 Reconnect the power cable and turn on the printer.
- 9 Open the top cover, close it again, and then press  (Go) if the Go light is flashing. If the Attention light is still blinking, then there is another jam. See "To clear jams from inside the printer" on page 165 and "To clear jams from input areas" on page 166.